

LEAPING LIZARDS SCHOOL & CAMP, SINCE 1989

CURRICULUM PHILOSOPHY

Children and young adults possess a natural curiosity and a need for creative discovery. By exposing them to a variety of ideas, activities and facts, you can help them use their skills in imagination, observation, and critical thinking to understand new concepts.

Our art curriculum has been developed by the director and prepared by the staff for the enjoyment of the children. Our curriculum meets and exceeds New Mexico state standards.

The goals are:

- To provide a wide variety of quality enrichment materials that are easily accessible to teachers and the children.
- To provide ideas for new activities that are developmentally appropriate for children in our care.
- To show how materials can be used within a wide range of activities.
- To maintain enthusiasm in new and existing curriculum development.
- To inform teachers of additional resource people and materials that are available to them.
- To provide ongoing training that fulfills the requirements of Leaping Lizards School and Camp.
- To maintain a catalogued Resource Library of a selection of books, videos, and tapes for teachers to browse through and use during visits.

Some of the activities and materials are intended for adults to work along with the children, while others encourage independence. In order for each child to gain the maximum benefit from the activities it is necessary to consider each child's developmental level and to adapt and individualize each activity as much as possible.

LEAPING LIZARD'S GOAL

Leaping Lizards is an educational institution based on the arts. Our goal is to provide a safe and loving environment in which children can evolve into happy kids equipped with a wide range of skills, including language, math, science singing, circle time and arts and crafts, outdoor education, social, and emotional skills. Our exciting program for older children include an introduction to song writing, video recording, arts and crafts, world wide music, physical education, and field trips. We encourage children to share and to play, fostering cooperative learning. Most important of all, our school and summer camp are places where a child can experience love and friendship away from home.

A child's time at school is precious, and we at Leaping Lizards encourage parents to share in it as much as possible. We invite you to share your special skill or talent with the children.

Children love it when their parents are involved!

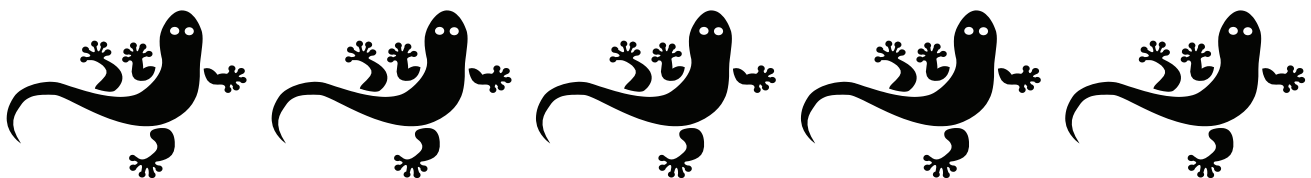

POB 2839 TAOS, NM 87571
(575) 758-1311

MUSIC ROCKS CAMP

Ages 6-11 children are separated into age groups. Older Kids may play instruments and want to bring in their own band/musical ideas. Younger kids can play some percussion, homemade instruments and a large variety of music instruments from around the world.

GOAL

This program is to inspire students to write about their interests and experiences and record their own songs and create music video to go along with some chosen songs from the program. All children will collaborate in groups to ensure a well rounded program. Students will leave the program with a professionally recorded CD demo of their song, a professional music video on DVD will be created to represent our high quality music program (available to parents).

METHOD

We will take experiences from field trips and their day to day lives; create brainstorming sessions to craft their own concepts and lyrics. From these lyrics and ideas they can then choose a musical style to write in: Blues, Rock, Metal, Country, Hip-Hop, etc... They will be shown examples of these styles and hone in on the style that most interests them for their songs.

MUSIC AND VISUAL ARTS

Educational aspects: - Students learn basic music terminology as well as a brief history of the various musical styles they choose to work in. Students create story boards for video ideas in order to formulate a concept and ideas for what they want to say visually in the videos. What story do they want to tell with their song and their video? They may do art projects, models, paintings, etc... For parts in their videos. Some older kids may be interested in the technical aspects of recording and producing: they may assist me and learn to record, edit, etc...The same goes for the video aspect. Older kids can help run the crew, lights, sound, editing, etc...

LANGUAGE ARTS

Rhyme scheme, vocabulary, synonyms, metaphors and more depending on age group

BASIC MATH

Understanding and counting rhythms and beats

SOCIAL STUDIES AND CURRENT EVENTS

Anything current that comes up socially may be great material for a song also news paper articles and books that may interest the kids can be read to inspire them.

SOCIAL AND INTERPERSONAL ASPECTS

Students learn to collaborate and communicate their ideas in a respectful and articulate fashion. They learn appreciation of music as a "**shared experience**", one that always proves the saying "two heads are better than one".

COMBINATION OF MUSIC AND VIDEO

Students will create the music CD in the first part of the session, then do all brainstorming and story boards for their video ideas, and shooting and editing of them in the second part of the session.

AGE GROUPS AND CLASSES

There are three teachers in this class. We will separate the children in smaller groups of 4 or 5 for each song. This will enable us to create age appropriate songs in smaller groups.

LEAPING LIZARDS SCHOOL PROGRAM INFORMATION

Giggling Geckos Toddler Program

Experiential learning program for two to three year olds; minimum 2 days a week, 2, 3, 4, and 5 day programs available.

Laughing Lizards Preschool

For children who are 3 & 4 years; minimum 2 days a week, 2, 3, 4, and 5 day programs available.

Lizard Wizards Pre-K

This program is for children ages 4 & 5 and is available 3, 4, or 5 days a week.

Music Rocks Summer Camp

This program is for children ages 6-11 years. Available 5 days a week only.

Winter hours

- Our hours of operation are 8-5 daily for younger children. We recommend 9-4 due to the long day for young children.

Summer hours

- Hours for all children students are 8-4. 5 days a week. After care available 4:00 to 5:00 no charge. Limited space
- Leaping Lizards provides a morning and afternoon snack
- You will need to provide a healthy lunch with an ice pack
- All children ages 2-5 must have a rest time or naptime of 45 minutes, this is a state regulation.

Summer Camps

One three-week session and one four-week session, for ages 2-3 (Toddlers), ages 3-5 (Nature Camp), and ages 6-11 (Music Rocks Summer Camp).

ENROLLMENT

A non-refundable enrollment fee of \$100.00 is due with a signed contract in order to enroll a student. You can deduct your enrollment deposit from your first month's tuition. It is important to enroll as early as possible for two reasons: (1) historically, we fill our vacant spaces very quickly, and (2) knowing all the children as far ahead as possible helps us to plan the best possible school year for everybody!

RATE SCHEDULE

Charges are due by the 1st of each month and are payable by the 10th of each month. There will be a \$25.00 late fee for any late payment. The monthly rate is based on the number of days your child attends each week.

The daily rate is \$34.00 per day plus NMGRT (currently 8.1875%) this daily rate is comprised of:

“TUITION” - 70%

“REGISTRATION/EDUCATIONAL FEES” - 30%

In the event of absence due to illness or school holiday closings, the monthly rates remain the same. There are no make up days for missed school days. (Drop in days are available for \$37.00 including NMGRT.)

Unfortunately, if your monthly bill has not been paid by the end of the month, your child will be withdrawn from our program.

Special payment arrangements must be made in advance.

At Leaping Lizards School we accept CYFD assistance for 2-11 years old. The CYFD assistance will be applied first towards “Tuition” with any balance applied towards “Registration/Educational Fees”. Parents are responsible for any remaining balance due towards the “Registration/Educational Fees”.

This is payable directly to Leaping Lizards School.

LEAPING LIZARDS SCHOOL PROGRAM INFORMATION

LATE FEE

DURING THE SCHOOL YEAR,

If your child is picked up after 5:00 PM there will be a \$10.00 late fee. For every additional 10 minutes there will be an additional \$10.00 late fee. This is strictly enforced.

Summer Camp is over at 4:00 PM. Music Rocks children need to be picked up by 4:00 PM. However, after care is available until 5:00 PM for an additional \$4.00 fee, but your child must be **pre-registered** for after care. This service is primarily for working parents. Otherwise, the same late fee structure applies to summer camp.

MATERIAL FEE: A materials fee for the nine month school year is due in September. This is a one-time annual charge of \$200.00. If you are paying annually, and your child attends school 3 or more days a week, the annual \$200.00 material fee will be waived.

Summer Camp Material fee is \$35.00 per child per session in our Nature Camp and Music Rocks Camp. No Material fee for toddlers.

Leaping Lizards School, a duly licensed school program is owned by Leaping Lizards Limited, a New Mexico corporation of which Jill Sanger is President. The contents of the Parents' Handbook are presented for information purposes and are part of your child (ren)'s enrollment agreement. These contents may be changed at any time at the sole discretion of Leaping Lizards School.

HIRING POLICIES

Physical Examination

All Leaping Lizards' employees must present at the onset of employment a certificate showing freedom from all communicable disease. Before hiring, an employee may be required to pass a physical examination. After hiring, an employee may be asked to take another physical exam, conducted by a Leaping Lizards School appointed physician, if any question regarding that employee's health arises.

Criminal Records Check

All employees who work directly with children are required by New Mexico state law to submit two fingerprint identification cards, which will be sent to the F.B.I. for a check on past criminal activity. These cards are available from the Leaping Lizards School Director and must be submitted within thirty days of employment.

Qualifications

To qualify for a permanent teaching position at Leaping Lizards School, a teacher must have a teaching credential or sufficient relevant experience to satisfy Jill Sanger, and as may be required by the Licensing and Certification Bureau of the Public Health Division of New Mexico Health and Environment Department. The state requires that one teacher in each classroom is to be current in First Aid and or CPR.

Personnel Administration

The task of handling Leaping Lizards School personnel records and related matters has been assigned to Jill Sanger. Any request to release personnel information must be put in writing.

PROCEDURES

Bulletin Boards

Bulletins and notices on the official Leaping Lizards School bulletin board are our official way of keeping you informed about new policies, procedure, and special events. Only authorized personnel are permitted to post, remove, or alter any notice.

LEAPING LIZARDS SCHOOL PROGRAM INFORMATION

Parking

You are encouraged to use our parking area for the pickup and delivery of your child. Please lock your car. Leaping Lizards is not responsible for loss or damage due to theft, vandalism or collision to your vehicle and / or its contents.

Sexual and/or Child Abuse or Neglect

The Leaping Lizards School staff is responsible for being continually observant and alert to any changes in the child(ren)'s behavior or physical appearance, which might suggest abuse or neglect. Any teacher who has any concerns of this nature must report them immediately to the Leaping Lizards School as mandated by New Mexico State law. Appropriate action will follow. Any changes in the N.M. State law regarding the reporting of suspected abuse shall supersede the provisions of this handbook.

Enrollment Procedures

The enrollment of new Leaping Lizards School students to the master schedule shall be the responsibility of Jill Sanger or Darla Garcia. No teacher shall enroll a new student to the master schedule or provide orientation to new families without the expressed authorization of Jill Sanger.

No Show Policy

Leaping Lizards School has a 10 day no show policy. If your child does not attend school for 10 days consecutive with out notifying our director Jill N. Sanger or our general manager, your child will be withdrawn from our school. Upon returning to school you must pay any past due tuition and the month's tuition in full.

School Hours

Leaping Lizards School normally operates on a five day, 45-hour workweek, Monday through Friday. In order to meet the needs of the community, Leaping Lizards School is open from 8:00AM to 5:00PM.

Summer Camp Hours

Leaping Lizards Summer Camp hours are 8:00 a.m. to 4:00 p.m. After care available for 2-11 years old.

Potty Training

In order to be enrolled in our Pre-School or Pre-K class your child must be potty trained, as these classrooms are not set up to accommodate changing diapers or pull-ups. The only classroom that is set up to change diapers is our toddler class. A child can not be enrolled in toddler class past the age of three.

Absences

In the event of absences due to illness, vacation, snow closings, or school holiday closings, the monthly tuition rates remain the same. There are no make-up days for missed school. Notify Leaping Lizards as soon as possible if you know your child will be out of school.

Celebrating Holidays

At Leaping Lizards we do not celebrate holidays. This has nothing to do with religious beliefs; we just feel that children are inundated with commercial holiday advertising months before the actual holiday. Our kids seem to do their best when their lives are predictable and consistent. So we choose to stay focused on our themes without distraction.

Birthdays

Parents are encouraged to have their child share his/her birthday with the class. Please give the staff a few days notice. Try to keep these foods healthy, no food high in sugar or lots of frosting.

LEAPING LIZARDS SCHOOL PROGRAM INFORMATION

Child Discipline

Discipline means training that enables the child to develop self-control and orderly conduct in relationship to peers and adults:

- A. Discipline shall be clear and understandable to the child, consistent, and explained to the child before and at the time of any disciplinary action.
- B. Discipline shall include positive guidance, redirection, and setting of clear-cut limits, which foster the child's own ability to become self-disciplined using love & logic and conflict resolution.

The following disciplinary practices are prohibited at Leaping Lizards School:

- A. Physical punishment of any type.
- B. Withdrawal of food, rest or bathroom opportunities.
- C. Abusive or profane language.
- D. Any form of public or private humiliation including threats of physical punishment.
- E. Unsupervised isolation of the child
- F. Any type of punishment that is hazardous to the physical, emotional or mental health of the child.

There are certain behaviors that can not be tolerated at Leaping Lizard School for example: biting, sexual abuse, kicking, spiting, choking, foul language or any type of behavior to hurt another child or teacher, also destruction of any school property (toys, books or playground equipment) cannot be tolerated. THESE TYPES OF BEHAVIOR CAN BE GROUNDS FOR WITHDRAWING A CHILD.

Health and Safety

Leaping Lizards School has taken steps to provide its employees and children with a healthy and safe work environment. First aid kits are supplied by Leaping Lizards School and are located in the classroom. Staff must notify Jill Sanger or General Manager when first aid supplies are getting low. If a minor injury should occur on Leaping Lizards property, proper first aid should be administered and an incident report completed with copies provided to the Director and child's parents or legal guardian. Please advise Jill Sanger as soon as possible if your child exhibits signs of illness.

Trauma

If serious injury should occur on Leaping Lizards property, the following procedure will be followed:

- 1) Administration of temporary first aid to the extent of comfortable knowledge;
- 2) Immediate notification of Jill Sanger of the incident;
- 3) Immediate notification of the child's parent(s) or legal guardian;
- 4) Contact of the child's chosen medical practitioner for further instruction;
- 5) Arrangement of the child's transportation to his/her medical practitioner or to the hospital Emergency Room: and
- 6) Completion of an incident report to be delivered to Jill Sanger or General Manager and to the child's parent(s) or legal guardian.

Scheduling Policy

Your child's scheduled days must be consistent and predetermined. However, schedules can be changed or the number of days per week increased during the year if there is space. We need two weeks notice for a schedule change or the tuition rate will not reflect the change until the following month.

Registered children may "drop-in" for additional days with advance approval of the teacher if there is space available. Drop in fees are payable the same day. Drop-in fees are \$37.00 a day.

Withdrawal from the Program

Withdrawal from the program requires a 30-day advance notice given to the school in writing. Families are responsible for full payment for any month that your child attends the program. For example, if the school receives notice in mid-April that a child will be leaving the school in mid May, the family must pay for May in full. Monthly charges will be based on the attendance schedule in effect at the time of receipt of notice of intent to withdraw.

LEAPING LIZARDS SCHOOL PROGRAM INFORMATION

School Calendar

Closings: Labor Day 4TH of July
San Geronimo Day
Columbus Day
Wednesday before Thanksgiving
Thanksgiving Day / Following Friday
Winter Break (two weeks)
Martin Luther King Day
Good Friday
Spring Break

Poisoning

In case of poisoning or suspected poisoning, Leaping Lizards personnel will call the poison control center phone number which is located next to the phone and follow their instructions completely. Our first aid kit contains Syrup of Ipecac in case it is necessary to induce vomiting. We will not give any child Syrup of Ipecac without first contacting the poison control center or a medical doctor.

Fire Emergencies

Leaping Lizards School has taken the necessary precautions to provide your child with a school environment safe from fires. Employees of Leaping Lizards School are required to be familiar with all the exits in the building, all the locations of the fire extinguishers, and all the procedures to follow in a fire drill or a real emergency.

School Security

Leaping Lizards School is a closed campus. As such, all visitors are required to register with Jill Sanger before they are allowed to visit or observe in any part of the building or playground. Leaping Lizards employees are to notify the Director immediately if a visitor refuses to comply.

Leaping Lizards School will release children only to the proper individuals. Every class has a list of parents and authorized escorts, which will be updated upon notice. If another person is going to be picking up your child on a particular day, you should fill out the escort sheet for that day posted in all classrooms and notify your child's teacher and director. If an employee is unsure as to whether a particular person can pick up your child, it might be necessary to contact you. A child will not be allowed to leave Leaping Lizards School property until Leaping Lizards School staff is sure they are with an authorized escort. The police will be notified if necessary to prevent an unauthorized person from taking a child. In the event that a child is determined to be lost or missing Leaping Lizards will notify the police immediately. Our school hallway is monitored by security cameras; TV monitor is located in the office.

Field Trips

All field trips shall be noted on the Master Field Trip Schedule posted on the Leaping Lizards School Bulletin Board at least three days in advance of the trip. No child shall be allowed to go on a field trip unless his/her parents(s) or legal guardian has granted permission in writing. If we have any behavioral problems, your child will not be allowed on field trips.

Medication

No contagiously ill child will be allowed to attend Leaping Lizards School. In the event your child is on medications and you wish Leaping Lizards School Staff to administer such medication, you must sign Leaping Lizards School Medication Authorization and deliver it to your child's teacher.

Complaints

Please communicate any complaints to the Director Jill Sanger or the General Manager Darla Garcia as soon as possible.

LEAPING LIZARDS SCHOOL PROGRAM INFORMATION

Parent Involvement

A child's early years in school are precious, and we at Leaping Lizards encourage parents to share in it as much as possible. To this end, our program includes a few parent cooperative aspects. Parents share their special skills and talents with their child's class. Sign-up suggestions are on the parent signature page to help you decide what types of activities your parent involvement days will include.

Confidentiality

All information provided Leaping Lizards is strictly confidential. We do not share information. We do not give out contact information of students, parents, or employees.

FOODS AT LEAPING LIZARDS

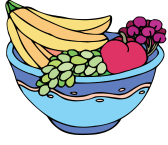

SNACK FOODS

At Leaping Lizards School and Camp we provide two healthy snacks daily, one at 10:00 a.m. and one at 3:30 p.m. At every snack we always serve a fresh fruit (apples, bananas, oranges, melons, berries when in season). We also serve vegetables (carrots, celery, cucumber, radishes, bell peppers and edamami, which is soybeans in a pod, the kids love them,) and ranch dip. Along with the foods mentioned we serve dry goods for example: graham crackers, Ritz crackers, gold fish, pretzels, animal crackers, and English muffins. We may add cheeses or cream cheese or peanut butter as a filling. We also make bean burritos and quesadillas. Another snack to accompany fruit is yogurt.

We often bake with the children. We make blueberry or apple muffins and cupcakes and cookies to be decorated by the children.

Please alert you child's teacher to any food allergies or other sensitivities.

LUNCH

Always pack a healthy lunch for your child. A lunch your child can manage easily.

Such as: Sandwiches Vegetables
 Fruit
 Salad
 Drink
 Dessert

You can use a thermos for hot foods such as: Pasta
 Soup
 Mac & cheese

Label all food containers and lunch box.

Don't forget an ice pack and a spoon and fork if needed.

Remember no sodas, gum or candy in lunches.

No nuts in lunches, they are a choking hazard.

BIRTHDAYS

To celebrate birthdays you are welcome to bring in a special afternoon snack. Notify your child's teacher in advance and bring enough snacks for the whole class (enough to feed 18). Remember to bring paper goods if they are needed.

We recommend: Cupcakes
 Cake
 Ice Cream
 Apple juice, milk or water for drinks,
 No Kool Aide or very sugary drinks or sodas

Leaping Lizards School & Camp

Health Policies

- Please do not send your child to school if he or she has yellow to green mucus. Take them to the doctor to make sure it is not a sinus infection.
- Remember your child should not attend until 24 hours after a fever has subsided.
- If your child has a persistent cough see a physician. If the cough persists your child needs to stay home for at least 4 days so that their lungs can heal and not spread germs. Your child will also need a doctor's note to return to school.
- If your child complains about a sore throat or pain when swallowing they should see a physician to make sure they don't have strep throat.
- If your child is not feeling well in the morning administering medicine such as Tylenol and sending him or her to school only masks the symptoms until later in the morning, by then all the other children at school have been exposed to your child's sickness. Please be considerate and help us to keep the children, staff and parents of our school healthy.

Swine Flu - H1N1

The symptoms of H1N1 (swine) flu in people are similar to the symptoms of regular human flu and include fever, cough, sore throat, body aches, headache, chills and fatigue. Some people have reported diarrhea and vomiting associated with H1N1 (swine) flu. In the past, severe illness (pneumonia and respiratory failure) and deaths have been reported with H1N1 (swine) flu infection in people. Like seasonal flu, H1N1 (swine) flu may cause a worsening of underlying chronic medical conditions.

In children emergency warning signs that need urgent medical attention include:

- Fast breathing or trouble breathing
- Bluish or gray skin color
- Not drinking enough fluids
- Severe or persistent vomiting
- Not waking up or not interacting
- Being so irritable that the child does not want to be held
- Flu-like symptoms improve but then return with fever and worse cough

Most important, make sure you have back up child care available when your child is not feeling well or needs an extra home day. Kids usually know these things but don't know how to convey it.

SCHOOL CLOSING POLICY

Leaping Lizards is a private school funded solely through tuition (until Pat wins the lottery and she shares). We do not receive any outside funding. Your tuition maintains our school such as rent, electricity, gas, and salaries, etc. To maintain our high quality standards tuition remains the same during school closings. Tuition also remains the same if your child is out due to illness, vacation, snow closings and legal holidays.

Our overhead expenses remain the same when we are closed, and we pay our staff when we are closed. As you know, teaching is not a high paying job. We pay a competitive wage and have a highly skilled, stable, long-term staff to provide the best possible loving and caring environment for your child. We also bring in special guests such as local chefs, artists, and musicians and more.

We do our best to manage our funds carefully and are able to provide a high quality enriched environment, based on early childhood education for your child.

Leaping Lizards School & Camp

POB 2839 Taos, NM 87571

(505) 758-1311 *ph* (505) 758-2378 *fax*

e-mail: lizards@newmex.com

LeapingLizardsSchool.com

Dear Parents,

New Mexico State Licensing now requires that we have a disaster plan in place. At first I thought this was silly, but it is really very important. So we have created the following disaster plan in case of an emergency.

DISASTER LOCATION #1 LOS ANGELITOS 758-4274

DISASTER LOCATION #2 MOUNTAIN MOVERS 758-1643

TYPES OF DISASTERS

SNOW STORM

If there is a large amount of snow on the ground from the night before we will close school. The Director will inform the local radio stations KTAO 758-8882 and KKIT/KXMT 758-4491. Listen for the announcement.

If we are at school and it begins to snow heavy we will have early dismissal. We will inform the radio stations so they can broadcast a public announcement and we will call all parents.

THUNDERSTORM

Keep children calm. Keep them inside until the storm passes. If it is an extreme storm with high winds move all the children into the toddler room. This room has the fewest windows. Read stories and keep the children calm. The office will call parents.

FIRE

Any teacher can set off the fire alarm if need be. Staff is trained on the location and how to use alarm.

When the alarm goes off one teacher in each classroom guides the children out the door to our evacuation locations. The second teacher checks the room and bathroom looking for children that might be hiding and brings the attendance sheet and phone list and joins the class. Attendance is taken to insure everyone is accounted for and waits until all is clear before returning to the classrooms.

If we cannot return to the school we will go to disaster #1 or #2 location (location to be decided at that time). Parents and radio stations will be called.

BOMB

Notify police immediately **911**. Bring all children to disaster plan #1 location, Los Angelitos. The office will call parents and radio stations to pick up their children.

LOCKDOWN

If an unwanted person is hanging around the school notify the office immediately. We will call the police and the TCEDC office. Lock you classroom door and keep the children calm. We will tell you when it is all clear.

GAS LEAK

Remove all children from school and follow the same procedures as a FIRE DRILL. The office will notify the gas company and the TCEDC office.

EXPLOSION

Remove all children to plan #1 location, Los Angelitos. If any child is hurt call the EMT and the hospital if needed. The office will call police, fire department, TCEDC and parents.

POWER OUTAGE

No power – no school – If this happens at night we will notify the radio stations. Parent will keep their children home. If we are at school we will call the electric company and ask how long the outage will be. We will then determine if we need to send the children home. If so, we will notify parents and radio stations of school closing.

MEDICAL EMERGENCY

- a. Call the hospital
- b. Call the parent
- c. Call the ambulance
- d. Call poison control center

INTOXICATED PARENT OR ESCORT AT PICK UP TIME

Try to keep the child safe. Do not let the child leave with that person. Send your co-teacher to the office to call the parent or police. Do not put yourself in harms way. If you have to let the child leave be sure to get the make model and license number of the vehicle for the police and call protective services.

IF WE CANNOT LEAVE OUR SCHOOL FOR SEVERAL DAYS:

- a. There are plenty of snack foods in cabinet under the birdcage in Pre-K and in the kitchen.
- b. There are extra diapers, wipes and rubber gloves in the changing.
- c. We have mats for all children and sheets and blankets and extra clothes in their cubbies.
- d. First aid kits are in all classes and disaster needs are kept in the brown closets in all rooms.

Disaster Plan # 1

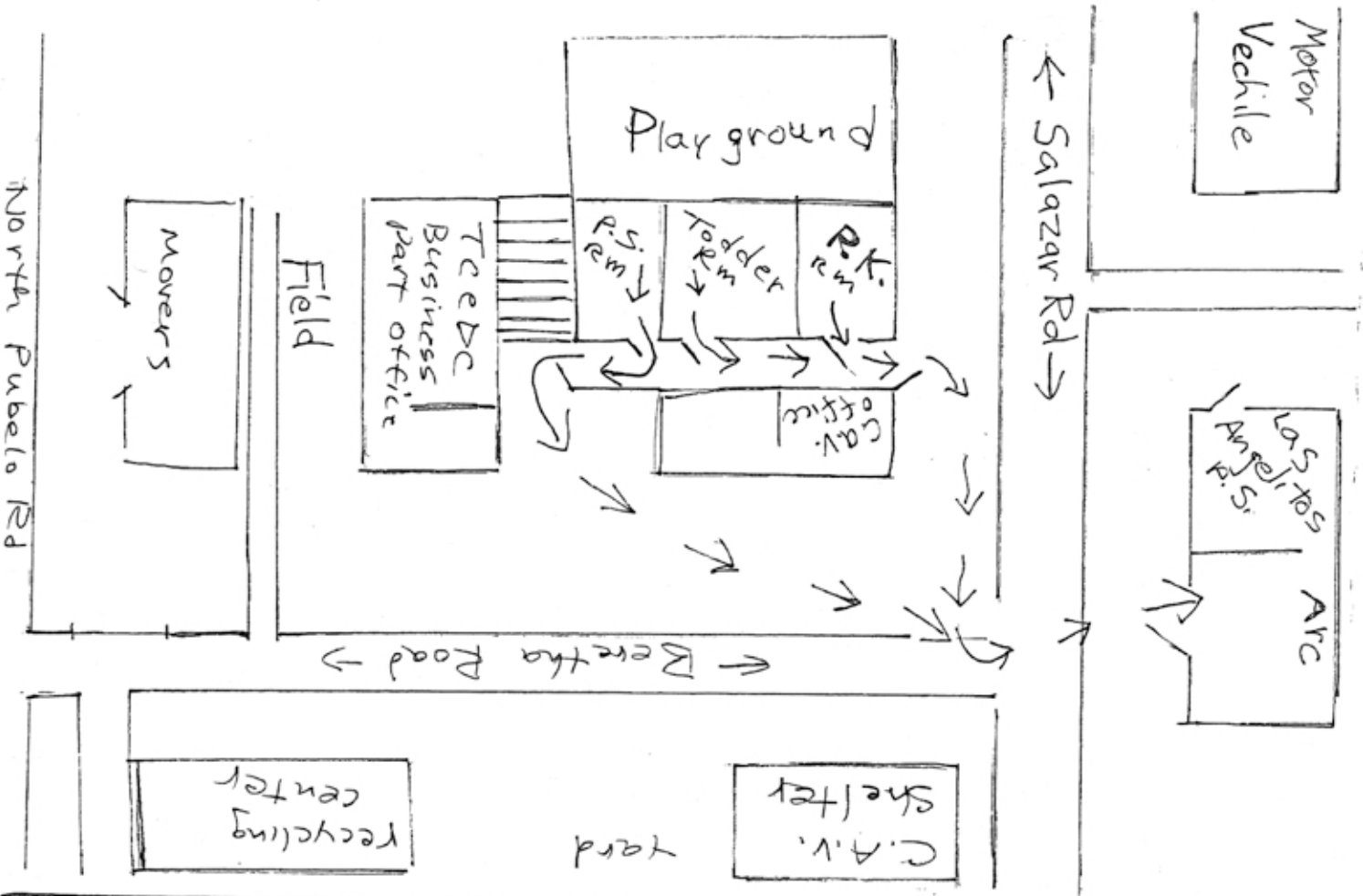

Disaster Plan # 2

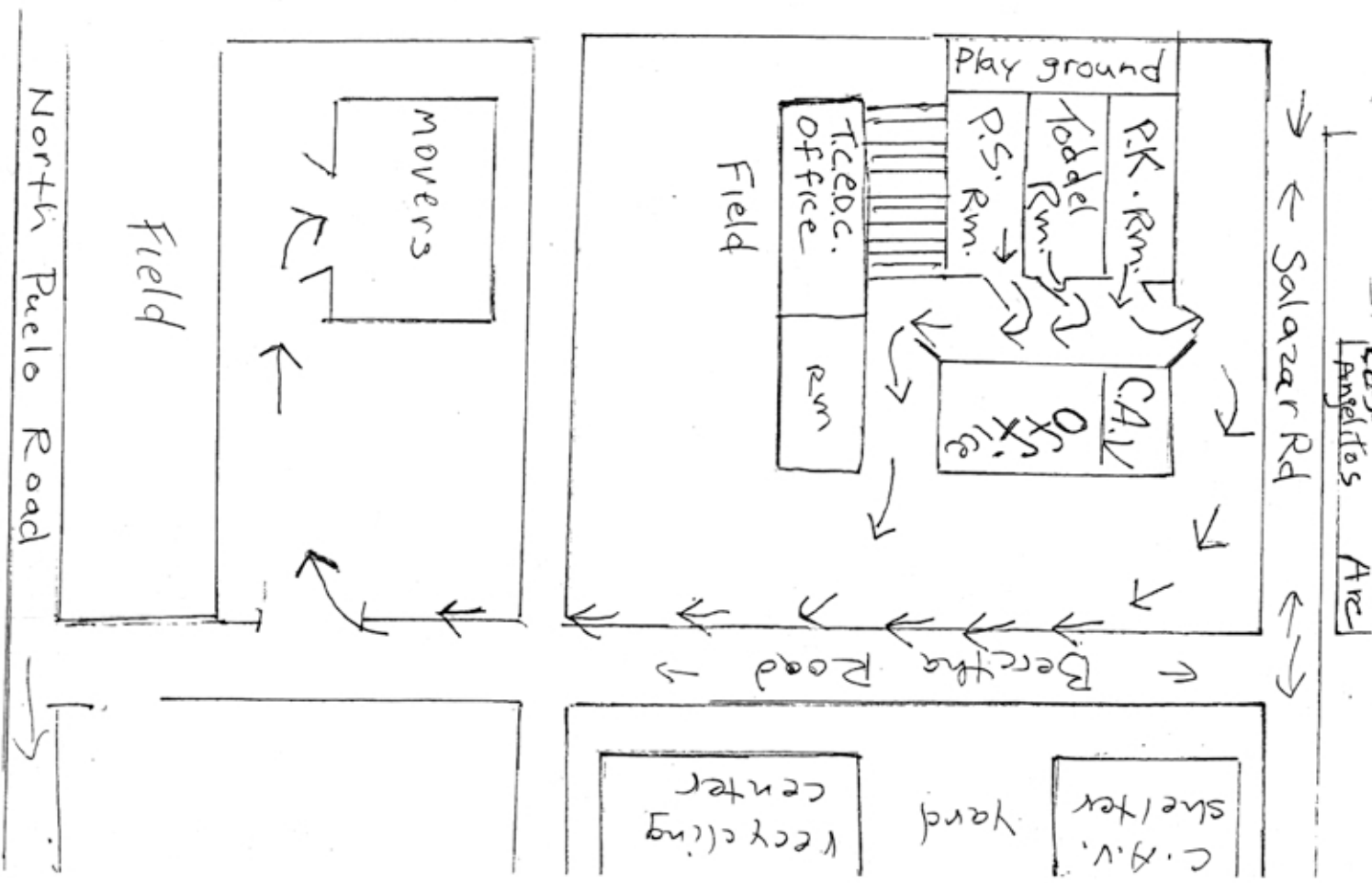

STUDENT NEEDS LIST

PLEASE LABEL ALL ITEMS

Toddlers Needs List

- ❑ A complete change of clothing to be kept in their cubby (shirt, pants, socks, and underwear)
- ❑ A crib sheet and lightweight blanket
- ❑ 4oz. or 8oz water bottle (no larger)
- ❑ Diapers and wipes (sorry, no cloth diapers)
- ❑ Large Zip-Lock bags for wet clothes
- ❑ 1 box of tissues
- ❑ Winter: hat, mittens that are easy on/off (no gloves), snow boots, snow suit/jacket
- ❑ Warm weather: hat with a rim, sunscreen

Pre-School and Pre-K Needs List:

- ❑ A complete change of clothing to be kept in their cubby (shirt, pants, socks, and underwear)
- ❑ A crib sheet and lightweight blanket
- ❑ 4oz. or 8oz water bottle (no larger)
- ❑ Winter: hat, mittens that are easy on/off (no gloves), snow boots, snow suit/jacket
- ❑ Warm weather: hat with a rim, sunscreen

Lunch:

- Lightweight lunchbox
- Icepack for lunchbox
- Drink –no glass bottles-box juice etc. are fine
- NO candy, gum or soda
- All other treats are fine, cookies, granola bars, fruit snacks, yogurt etc.
- Napkin and plastic utensils if needed

Dress your child comfortable. No open toe shoes if possible and no cowboy boots.
This is safety practice.

LABEL, LABEL, LABEL, LABEL, LABEL, LABEL, LABEL, LABEL, LABEL!!!



PARENT HANDBOOK ACKNOWLEDGEMENT

I _____, as parent / legal guardian of

Name(s) if Child (ren)

Do hereby acknowledge that I have received, read, and understood the Leaping Lizards School Parents Handbook and Child Discipline Policy.

I understand that no refunds or fees of any kind will be made after my child (ren) begins school.

I hereby agree to release and indemnify Leaping Lizards School, its officers, directors, employees, and agents and their successors and assigns from any and all claims and liabilities (including court and attorneys fees) arising out of or in connection with my child (ren)'s participation in Leaping Lizards School.

Signature of Parent or Guardian

Date

Please check off your interests or special talents:

- | | |
|--|---|
| <input type="checkbox"/> Reading to children | <input type="checkbox"/> Cooking |
| <input type="checkbox"/> Art | <input type="checkbox"/> Storytelling |
| <input type="checkbox"/> Woodworking | <input type="checkbox"/> Music-all types, singing,
Playing an instrument, making simple
Instruments |
| <input type="checkbox"/> Clay work | <input type="checkbox"/> Prop box items-Theme related |
| <input type="checkbox"/> Field Trips | <input type="checkbox"/> Face or body painting |
| <input type="checkbox"/> Playground work | |
| <input type="checkbox"/> Sewing – Dress-up clothes
And costumes | |

Other (please list): _____

